

昆 仑 科 技

www.koontech.com

香港昆仑科技（深圳）有限公司

Regular Customer

THALES SIEMENS



Alcatel-Lucent



HUAWEI

ERICSSON
TAKING YOU FORWARD

AVAYA
The Power of We



SOS telephone GSM KNEM-25



The most professional manufacture in Asia The exclusive supplier for all Metro project in China

The Weatherproof phone will be designed to work on Railway, metro, tunnel, etc. Housed in robust aluminium die case with spring loaded door, it will offer protection against the outdoor environment, vandals resistance and rot resistance.

The unit will meet all the latest European/UK standards for EMC and US FCC, telephony, waterproofing IP67, and lightening protection together with offering the level of performance and reliability demanded in such an environment.

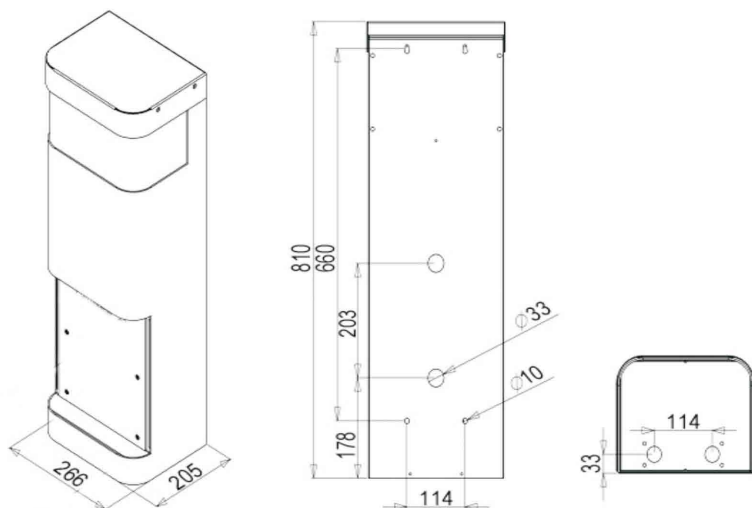

Main Product features

1. GSM/ VOIP/PSTN optional.
2. Matell body, solid and temperature bearable.
3. Handset free, loudspeaker.
4. Heavy duty Vandal resistant buttons.
5. With or without keypad optional.
6. Lightning protection standard to ITU-T K21.
7. Waterproof grade about IP55.
8. Body with grounding connection protection.
9. Support hotline call, self stop if the other side hang up.
10. Built-in loud speaker, noise canceling microphone.
11. Lighting will flash when there is a incoming call.
12. AC 110v/220v powered or built-in rechargeable battery with solar powered panel optional.
13. The design is super thin and smart. Embed style and hanging style can be chosen.
14. Time out function optional.
15. Colours: RED + Stainless steel , If the qty over 100pcs can be To customer specification.

- Standard and SMART Analogue and VoIP-SIP options available
- DTMF(Dual Tone Multi Frequency)
- Matching with most PABX,PBX and PAX systems.

Main PCB

1. Well treated PCB used inside the phone.
2. Robust screw terminals used for the connection of ringer, handset, line in, hookswitch.
3. Selectable 7 minute time out, to release the line if the handset is left off hook.
4. All connectors be greased in production.

VOIC OVER IP- SIP (Version)

Connection type: RJ45 Socket inside sealed enclosure

Power supply: External 24V dc

Call set-up Protocol: Session Initiation Protocol(SIP)

Configuration: DHCP or STATIC IP address provisioning



1 2 3

The most professional manufacture in Asia
The exclusive supplier for all Metro project in China

Telephone layout



Mounting bracket

Connection cable

Stainless steel connection cable to exchange.
Well treated keep waterproof.

Packing detail:

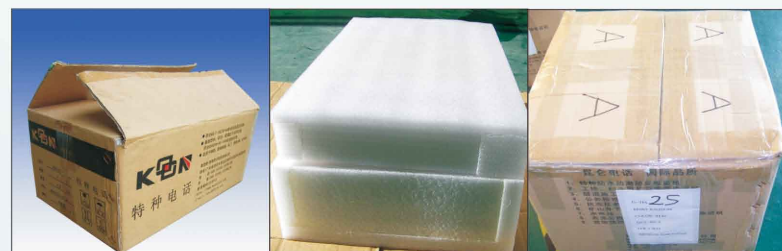

Unit size: 300*180*125mm, N.W: 3.3KG

1pcs in each inner CTN box, size: 439*277*191mm G.W: 4KG

4pcs in outer CTN box, size: 566*445*420mm G.W: 17.3KG

TECHNICAL SPECIFICATION

- Network Interface:** GSM Frequency : 850/900/1800/1900MHZ
- Ringin:** Through internal Speaker/ringer
- Power Supply:** Re-chargeable Battery powered: 9V/14Ah, Solar back-up: 12V/30W
- Time out:** selectable 0-20 minutes
- Temperature:** -20°C~ +60°Cemp
- Relative Humidity:** up to 90%
- Built-in battery Standby:** 21days
- Built-in battery talking time:** 21 hours

Certification:



EMC: EN50121 (Railway application-
Electromagnetic Compatibility)

EN55022: emissions

En55024: immunity

FCC

ITU-T Recommendations K21